



Build With Purpose

SUBMITTAL FORM P-RH2 Post Mount Roof Hydrant

JOB NAME _____

JOB LOCATION _____

PART NO# _____

ARCHITECT _____

ENGINEER _____

CONTRACTOR _____

FEATURES

- Optional ASSE 1052 approved P-004 vacuum breaker and dual backflow preventer available
- Patented PRIER "triple seal" positive shutoff system offers triple redundancy to assure shutoff
- Adjustable bracket to accommodate roof angles up to 2/12 pitch
- Hydrant has 3/4" inlet and multi-pass seat for high flow rates
- Outlet stands up to 30" above the roof for easy hose access

Certifications

- ASSE 1052
- C-UPC
- CSA B64.2
- ASME B1.20.1

PART NUMBER

P-RH2

→ H2- Post Mount Roof Hydrant
Includes Roof Hydrant Mounting Bracket

Find us in

MasterSpec®

a product of The American Institute of Architects



DIMENSIONS

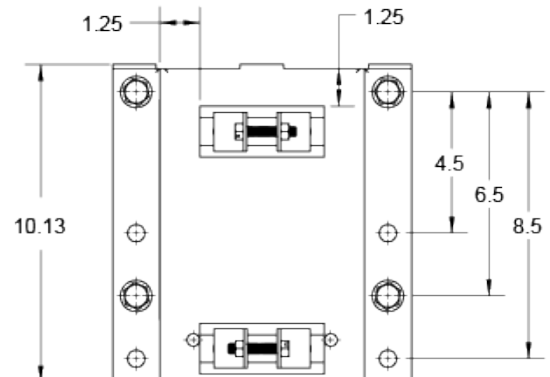
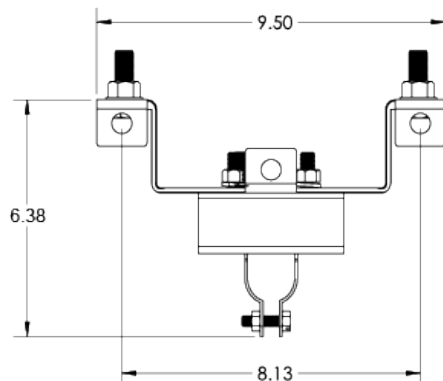
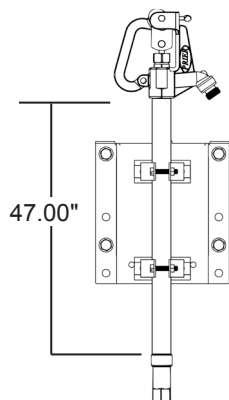



Build With Purpose

SUBMITTAL FORM P-RH2 Post Mount Roof Hydrant

MATERIALS

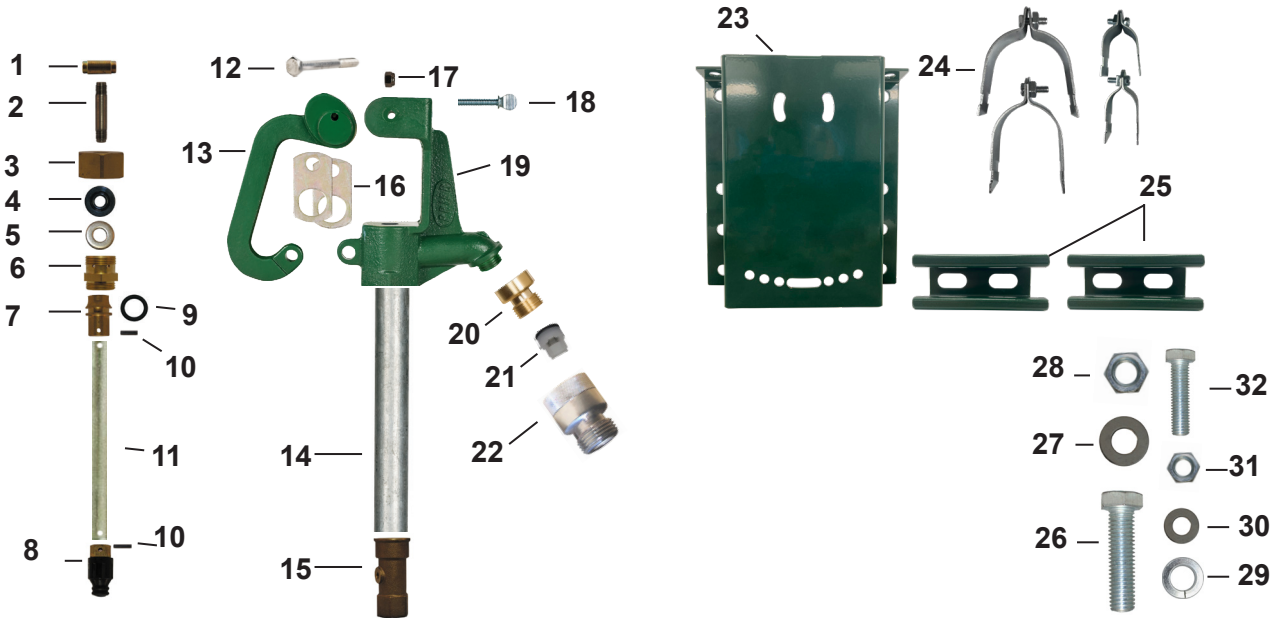

ID	PART	MATERIAL	ID	PART	MATERIAL
1	Adjustable Connector Nut	Plated Steel	21	Check Valve	Composite
2	Upper Rod	Stainless Steel	22	ASSE 1052 VB & Backflow Check Valve	See Below
3	Valve Stem Cap	Brass		Hose Piece	Nickel Plated Brass
4	Packing	EPDM		Adapter	Nickel Plated Brass
5	Washer	Stainless Steel		Washer	Silicone
6	Seal Adapter	Brass		O-Ring	EPDM
7	Seal Sleeve	Brass		Check Spider	Acetal
8	Stopper	Brass and EPDM		Check Valve	Composite
9	O-Ring	EPDM	23	Mounting Bracket	Powder Coated Steel
10	Spring Pin	Stainless Steel	24	1" Pipe Clamp Assembly for P-RH1, P-RH2, P-RH3	Zinc Plated Steel
11	Rod	Galvanized Steel		2 1/2" Pipe Clamp Assembly for P-RH4	Zinc Plated Steel
12	Handle Bolt	Stainless Steel	25	Unistrut Steel Struts	Powder Coated Steel
13	Handle	Cast Iron	26	1/2" Mounting Bolt	Zinc Plated Steel
14	Pipe	Galvanized Steel	27	1/2" Flat Washer	Zinc Plated Steel
15	Seat	Brass	28	1/2" Mounting Nut	Zinc Plated Steel
16	Draw Straps	Plated Steel	29	3/8" Lock Washer	Zinc Plated Steel
17	Lock Nut	Stainless Steel	30	3/8" Flat Washer	Zinc Plated Steel
18	Flow Screw	Zinc Plated Steel	31	3/8" Hex Nut	Zinc Plated Steel
19	Hydrant Head	Cast Iron	32	3/8" Bolt	Zinc Plated Steel
20	Hose Piece	Brass			

SPECIFICATIONS

Furnish and install Model P-RH2 Commercial Post Mount Roof Hydrant manufactured by PRIER Products, Inc. Hydrant shall be installed through a 1 3/4" single penetration in the roof and mounted to the interior structure with the Universal Roof Hydrant Mounting Bracket (P-RMB) provided. This bracket must be manufactured of heavy gauge powder coated steel and must allow for adjustment to meet roof angles up to 2/12 pitch. The mounting bracket shall be mounted to concrete, a roofing truss, steel I-beam or interior wall with standard construction materials (threaded rod, Unistrut or other). The hydrant shall have automatic draining capabilities with optional vacuum breaker/backflow preventer. Hydrant head shall be cast iron with freezeless water flow and self draining functions, one piece valve plunger and a triple-seal shut off mechanism. The hydrant shall have a 3/4" NPT inlet and a 1/8" NPT drainage port to be connected to the drain waste line inside the structure. The roof penetration is to be sealed by the roofing contractor in accordance with the roofing codes and conditions in their municipality.