



Installation, Operation & Maintenance Instructions for the PRIER P-623 & P-628 Narrow Wall Hydrant

Please leave this sheet for the property owner

Build With Purpose

The PRIER P-623 & P-628 Narrow Wall Hydrants are made to fit in thin 2x4 wall construction and is to be used in interior or exterior non-freeze areas. These hydrants can be installed in any orientation to accommodate the different directions of the water supply.

1. HYDRANT BOX INSTALLATION

1. Determine where on the wall you want to install your hydrant.
2. Determine direction of water supply. The box can be installed 4 different directions. Separate door frame from box and valve assembly.
3. Using standard building materials (supplied by others), build a frame for the 4 screw holes to attach on the back of the box, similar to the examples below. The screw holes are 7" apart from each other.
4. Align front of box approximately 1/8" behind face of finished wall.
5. Four #10-12 1" long SS screws are included with this product. Use holes in each corner of the box to secure the box to framing structure. Mount so the box opening will be no more than 1/8" behind finished wall.

Note: The separate door frame does not need to be installed at this time to make access easier. Make sure the installation is secure.

6. The hydrant body is now installed and ready for Step 2.

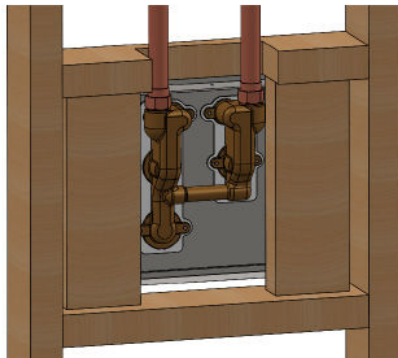

Installation with Frame
(Hardware not provided)

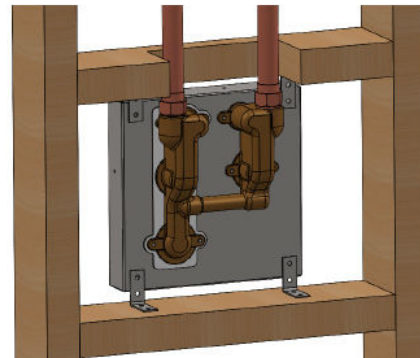

Installation with Stub out Bracket
(Hardware not provided)

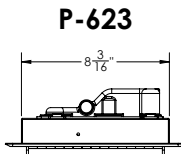

P-623

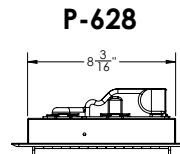

P-628

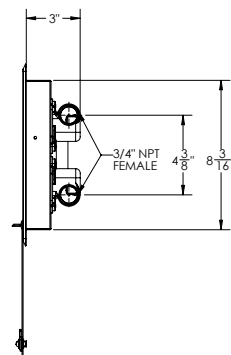
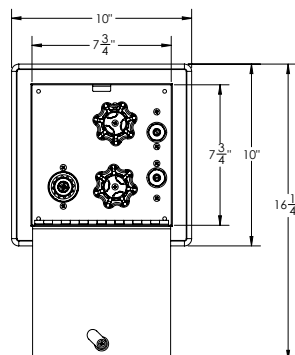
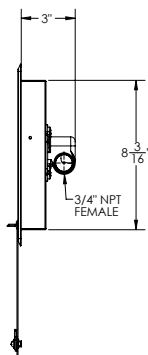
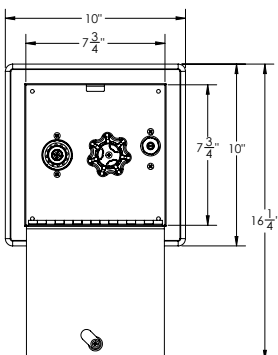



Build With Purpose

**Installation, Operation & Maintenance Instructions for the
PRIER P-623 & P-628 Narrow Wall Hydrant**
Please leave this sheet for the property homeowner

2. DOOR FRAME INSTALLATION

1. Insert the door frame into the mounted box. It can be oriented 4 ways and the wall depth is adjustable.
2. Use the 4 provided #8-15 x 1/2" long SS screws to secure the door assembly to the mounted box.

3. BOX SEAL INSTRUCTIONS

1. With the box fully seated and secured, the last step is to seal the box to eliminate leaks.
2. Apply caulk/silicone or equivalent to the side walls, between the door assembly and box, as well as around the mounting screw locations. Be sure to go around all metal edges. You do not need to seal around the valve, it is manufactured with a water tight gasket between the valve and the box.
3. Connect the hydrant inlet(s) 3/4" FPT to the water supply and test the installation for leaks with a closed end hose to pressurize system.
4. Remove protective film covering on exterior
5. You are now finished and have installed the Narrow Wall Hydrant.

4. MAINTENANCE

The PRIER P-623 & P-628 series hydrant leaves the factory fully air tested and operational. The hydrant requires no scheduled maintenance and will provide years of reliable service. If maintenance is required, the valve is equipped with an integral stop(s) that allows the valve to be shutoff to access internal components.