



4515 East 139th Street  
Grandview, MO 64030  
(800) 362-9055  
Fax (800) 362-1463

## INSTALLATION, OPERATION & MAINTENANCE INSTRUCTIONS FOR PRIER P-650 COMMERCIAL GROUND HYDRANT

### INSTALLATION:

Before installing the P-650 Commercial Ground Hydrant, please make certain the shutoff point of the Ground Hydrant is installed below the frost level to avoid freezing and assure proper drainage.

1. Dig a hole for installation that is 1 foot deeper than the hydrant length (if installing a 3' Hydrant, dig a 4' deep hole).
2. Put a cinder block or large stone at the bottom of the hole to support the installation of the ground hydrant and supply piping.
3. If using a hydrant box for the installation (P-650BX), install the hydrant through the box **BEFORE** installing the hydrant to the supply piping. You may install a 90 degree elbow in the drain port and orient it in the down position to aid in maintaining a clear drainage path.
4. After making sure the supply line is flushed of debris and foreign particles, install the ground hydrant to the supply piping. Teflon tape or pipe sealant will need to be used.
5. Prior to burying the hydrant, turn on the supply water to check for leakage and proper operation. Using the provided operating key, turn **ON** the valve and make sure the valve flows properly and no water is draining from the drain port during operation. Turn **OFF** the valve and make sure the water in the hydrant drains completely from the drain port.
6. After assuring proper installation, bury the base of the hydrant, 12" minimum in gravel to assure proper drainage. **DO NOT USE SAND** as this may clog the drain port.
7. After making sure the hydrant is straight, bury the remainder of the hydrant with fill dirt to proper grade height.

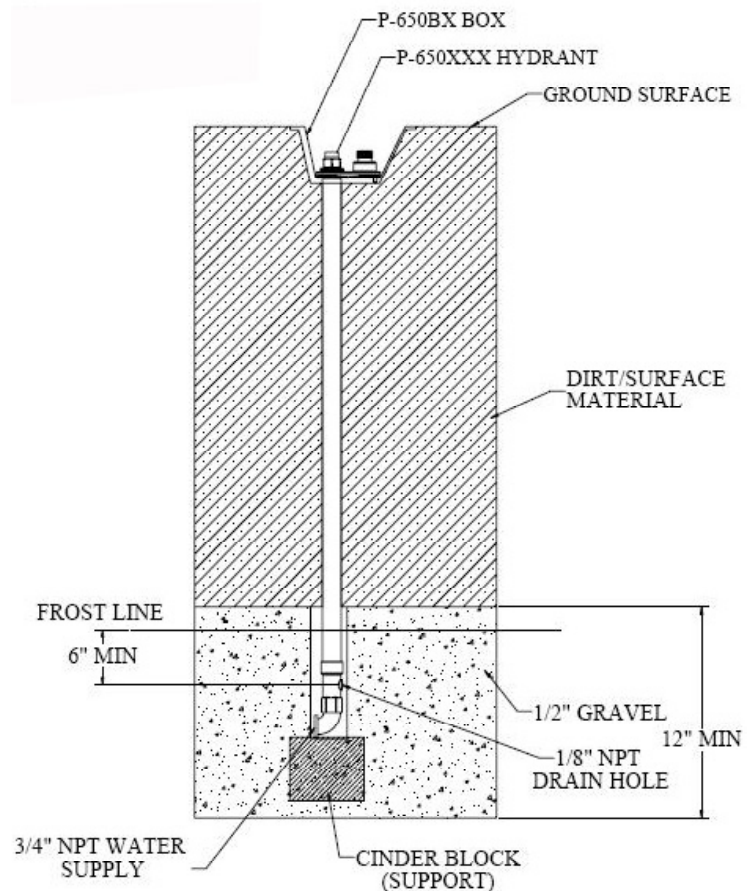

P-650 Typical Installation

### OPERATION:

The operation of a PRIER P-650 Ground Hydrant is simple.

Turn the valve counterclockwise to flow water. The valve should begin to flow after two full revolutions.

Turn the valve clockwise to close and stop flow. Note the valve shuts off below the freeze line and after shutoff will drain into the ground to avoid freezing.

*Do not overturn when opening or closing the hydrant!*

Contact PRIER's Technical Service Department at 800-362-1466 if you have any questions.



4515 East 139th Street  
 Grandview, MO 64030  
 (800) 362-9055  
 Fax (800) 362-1463

**PARTS:**

- 300-6003 Valve Stem Cap
- C-634KT-809 Worm Stem Assy
- C-634KT-808 Worm Sleeve Assy

231-08XX Stem Assembly

P-260KT-802 Stopper & O-Ring Kit

Part No	Description
231-0801	Stem Assy for 1' P-650 Hydrant 13 1/8" OAL
231-0802	Stem Assy for 2' P-650 Hydrant 25 1/8" OAL
231-0803	Stem Assy for 3' P-650 Hydrant 37 1/8" OAL
231-0804	Stem Assy for 4' P-650 Hydrant 49 1/8" OAL
231-0805	Stem Assy for 5' P-650 Hydrant 61 1/8" OAL
231-0806	Stem Assy for 6' P-650 Hydrant 73 1/8" OAL
231-0807	Stem Assy for 7' P-650 Hydrant 85 1/8" OAL

C-634KT-806 Vacuum Breaker Replacement Kit

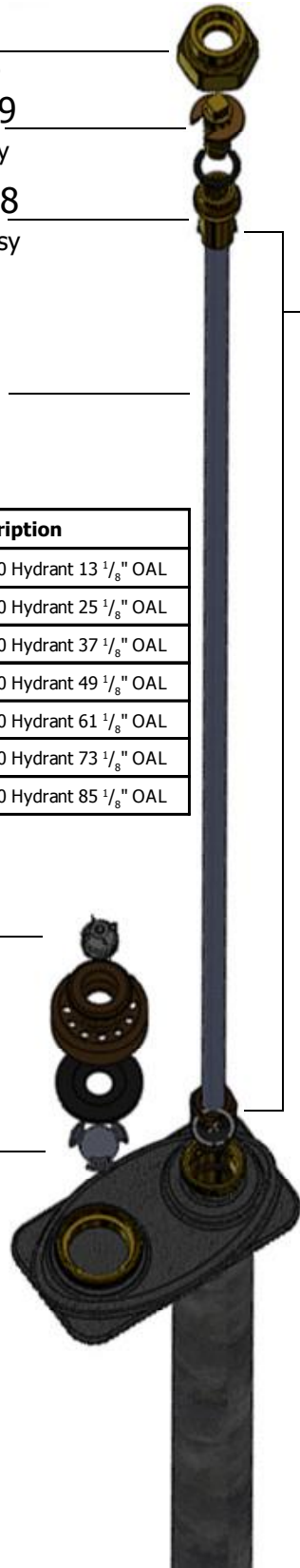

**ROUGH-IN DIMENSIONS:**

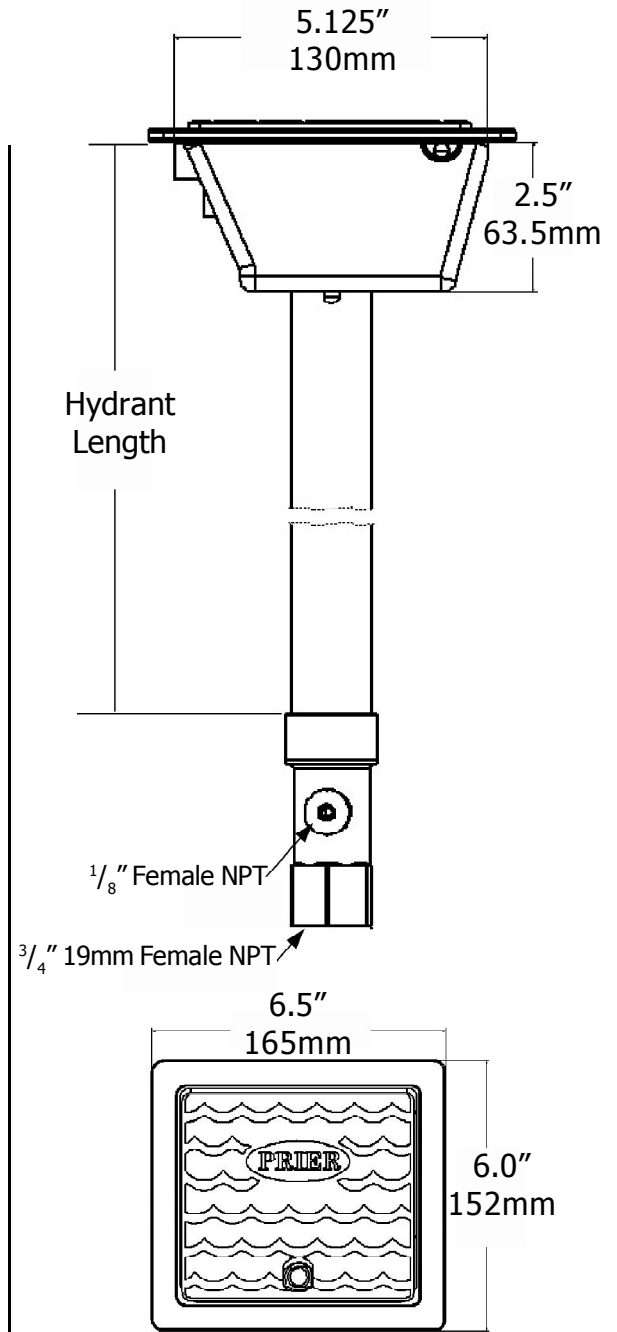

**MAINTENANCE:**

The PRIER P-650 Commercial Ground Hydrant requires no scheduled maintenance for long wear life.

Replacement parts are available for the P-650 from your local PRIER distributor.