



Installation, Operation & Maintenance Instructions for the PRIER C-633 Mild Climate Commercial Wall Hydrant

Please leave this sheet for the property owner

Thank you for purchasing the PRIER C-633 Mild Climate Commercial Wall Hydrant, the finest quality commercial hydrant available. Your C-633 will provide you years of dependable service with little or no maintenance. Please note: Your C-633 hydrant has drain holes under the packing nut. After shutoff, the drain holes will allow water to drain for a few moments to prevent freezing. This is normal and according to design.

Installation:

Installation procedures may vary slightly depending on the seat option purchased and the installation inlet options. The C-633 wall hydrant is available with the following inlet options:

N	1" MIP x 3/4" FIP
P	1" Male SWT x 3/4" Female SWT
V	3/4" ProPress Ready

**P and V inlets only available with CC length*

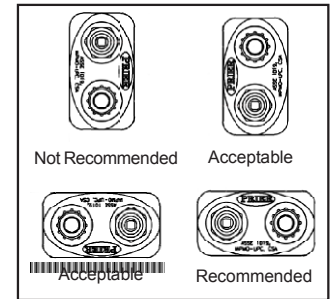

C-633NCC (Straight)

1. No special installation tools are required. Determine the location for installation of the hydrant. Be sure there is adequate piping to the wall for this shorter mild climate hydrant. This valve is designed for installation in either horizontal or vertical position. If installing vertically, install with hose connection in "up" position.
2. Using the template provided on the box, bore a 1-3/8" diameter hole through the wall in the desired position, and a 1/4" alignment hole that is 1/2" deep.
3. Insert the hydrant through the hole and secure it to the inside wall using the provided wall clamping ring. Seal through wall penetration if required.
4. Flush all foreign particles from the water line before connecting the hydrant.
5. Connect the water supply piping to the hydrant as desired. With a closed-end hose on the valve creating back pressure, test the installation for leakage.
6. If planning to solder the hydrant to the supply piping, open the hydrant to the full open position before soldering. Excess heat to the valve will damage the sealing surfaces on the stem of the hydrant.

C-633NSV (360° Swivel)

1. No special installation tools are required. Determine the location for installation of the hydrant. Be sure there is adequate piping to the wall for this shorter mild climate hydrant. This valve is designed for installation in either horizontal or vertical position. If installing vertically, install with hose connection in "up" position.
2. Using the provided template, Bore two holes through the wall and remove the excess material between those to create an opening for the swivel inlet of the valve.
3. Align your rotating inlet to the supply piping and secure the valve to the outside wall. Seal through wall penetration if required.
4. Flush all foreign particles from the water line before connecting the hydrant.
5. Secure the hydrant to the supply piping and test for leakage.

Operation:

Operation of the C-633 Mild Climate Commercial Wall Hydrant is a simple process. Water flows through the hydrant after turning the loose key one full turn counter-clockwise to the "on" position. The hydrant will achieve maximum flow at 2 1/2 full turns. Turn off the hydrant by turning the loose key clockwise to the "off" position. The hydrant will drain for a few moments. If the dripping persists after a few moments, tighten the key slightly until the dripping stops. Be careful not to overtighten the hydrant. The C-633 incorporates an integral atmospheric anti-siphon vacuum breaker that, in the rare occurrence of a back siphonage, opens to the atmosphere preventing contamination of the water supply. As well as an atmospheric vacuum breaker, the C-633 incorporates vacuum breaker check valve in the rare case that water is forced backwards into the valve.

ALWAYS REMOVE HOSE DURING FREEZING TEMPERATURES

INTENDED FOR IRRIGATION USE AND OUTDOOR WATERING

Maintenance:

The C-633 Mild Climate Commercial Wall Hydrant leaves the factory fully air tested and operational. It is treated with an FDA approved lubrication. The hydrant requires no scheduled maintenance to provide long life. If the stem is removed, the bypass O-Ring needs to be replaced and lubricated with an FDA approved lubricant to avoid tearing.



4515 East 139th Street
 Grandview, MO 64030
 (800) 362-9055
 Fax (800) 362-1463
 www.PRIER.com

Replacement Parts & Stems

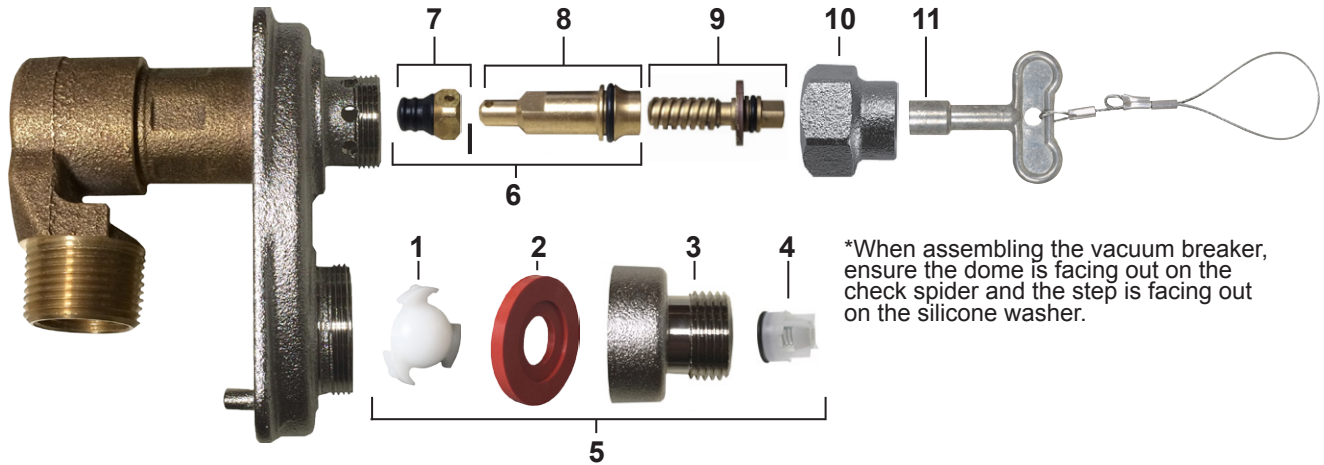

*When assembling the vacuum breaker, ensure the dome is facing out on the check spider and the step is facing out on the silicone washer.

ID	Part No.	Description	ID	Part No.	Description
1	337-6001	Check Spider-Vacuum Breaker	7	C-634KT-802	Stopper Kit, Includes Stopper and Pin
2	346-6001	Diaphragm-Vacuum Breaker	8	C-633KT-809	Worm Sleeve with O-Ring
3	300-6004	3/4" Hose Piece (NP Brass)	9	C-634KT-809	Worm Drive Assembly with O-Ring
	310-6009	1" Hose Piece (NP Brass)	10	300-6003	Valve Stem Cap (NP Brass)
4	399-0001	Secondary Check	11	C-108KT-808	Loose Key on Lanyard
5	C-634KT-806	Vacuum Breaker Assembly		C-633KT-807	C-633 Overhaul Kit, Contains: 5, 6, 9, 11
6	231-06CC	Stem Assembly			

Rough-In Dimensions

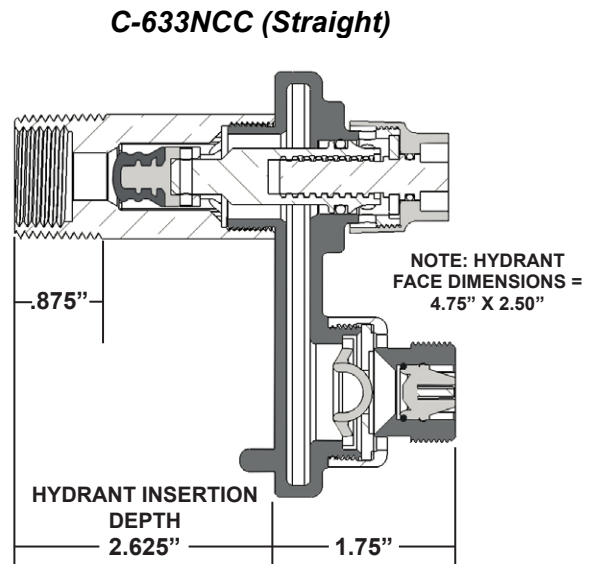
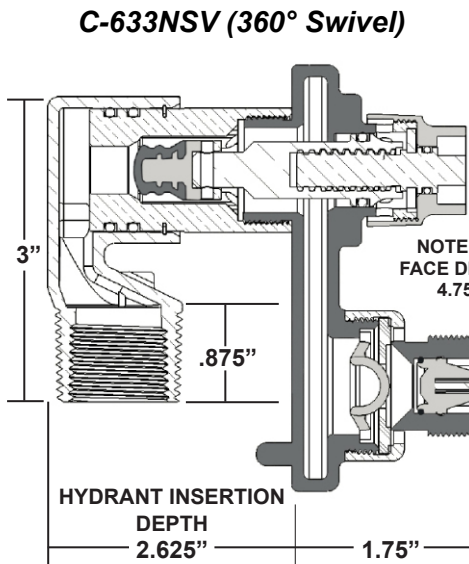

Specs

Furnish and install (choose C-633NSV Model or C-633NCC Model) commercial key operated wall hydrant manufactured by PRIER Products, Inc. Hydrant shall be surface mounted and shall have automatic draining capabilities with integral vacuum breaker/backflow preventer. Hydrant shall be capable of flowing a minimum of 15 gallons per minute at 25 PSI pressure change. Hydrant shaft shall be brass with threaded and sealed connections. Hydrant shall have (choose 3/4" or 1") hose connection with self draining functions, one piece valve plunger, satin nickel finish, brass operating rod with positive triple-seal shutoff mechanism. Hydrant shall be approved under ASSE 1019-B or ASSE 1052 (choose option) standards. Operating key with lanyard to be furnished with each hydrant. Hydrant insertion to be specified as C-633NCC (straight with 3/4" FPT x 1" MPT connections), C-633PCC (straight with 3/4" x 1" sweat connections), C-633VCC (straight with 3/4" press-ready connection) or C-633NSV (360° swivel with 3/4" FPT x 1" MPT connections).

Optional: Furnish and install hydrant box for each hydrant. Hydrant box shall be manufactured in solid cast brass with a (choose from natural brass or satin-nickel plated brass) finish. Access to the hydrant box shall be provided by (choose hydrant's key or cylinder lock and key).