



4515 East 139th Street
 Grandview, MO 64030
 (800) 362-9055
 Fax (800) 362-1463
 www.PRIER.com

C-534 Commercial Wall Hydrant

With Integral P-004 Vacuum Breaker



- Commercial
- Freezeless
- Anti-Siphon
- Double Check Valve



PRIER C-534 provides a year round source of water to areas of structures that are subject to freezing temperatures. The hydrant valve is connected to the supply piping in the heated portion of the structure, eliminating the possibility of freezing. To assure freeze protection, the hydrant will drain even with the hose attached and under pressure without sprayback!

The C-534 combines freezeless hydrant features with self-draining, anti-siphon and two backflow check valves! The vacuum breaker/backflow presenter provides protection against cross-connection of the potable water supply, while venting to eliminate any vacuum. The C-534 has an extended vandal proof lockshield with loose key. Upon closure, valve drains even with closed end hose attached. No special installation tools are required.

Application

Features

- ASSE 1052 and C-UPC approved
- Double check valve and anti-siphon vacuum breaker
- Drains automatically with hose attached
- Integral cast flange with built-in drainage pitch
- Solid brass body, valve stem cap, seat and stem ends
- Satin nickel plated body, cap and vacuum breaker
- Durable ACME threads secure stem at seat end
- Compact and powder coated cast aluminum handle
- Metal collar covers drainage holes and protects against insect nesting while closing under pressure
- Multiple vent holes ensure proper draining
- Cycle tested to simulate 25 years minimum service
- Patent protected
- Field testable as required by ASSE 1052

Inlet Styles



D Style
1/2" MIP x 1/2" SWT



X Style
1/2" Crimp PEX



T Style
3/4" MIP x 1/2" FIP



F Style
3/4" MIP x 3/4" SWT



FW Style
3/4" Wirsbo® PEX

Ordering

C-534D10

Inlet

- D- 1/2" MPT x 1/2" SWT
- X- 1/2" Crimp PEX
- T- 3/4" MIP x 1/2" FIP
- F- 3/4" MPT x 3/4" SWT
- FW- 3/4" Wirsbo PEX®

Length

- CC- Close Coupled
- 04- 4" Insertion
- 06- 6" Insertion
- 08- 8" Insertion
- 10- 10" Insertion
- 12- 12" Insertion
- 14- 14" Insertion
- 16- 16" Insertion
- 18- 18" Insertion
- 20- 20" Insertion
- 22- 22" Insertion
- 24- 24" Insertion
- XX- Special Size

Materials

| | |
|------------------------|---|
| Brass | Body, Stem Ends (2), Seat, Valve Stem Cap |
| Hard Copper | Operating Stem, Shaft |
| EPDM | Drain Seal O-Ring, Triple Seal Stopper, Packing |
| Silicone | Vacuum Breaker Washer |
| Acetal | Vacuum Breaker Check Spider |
| Stainless Steel | Seat Pin |
| Aluminum | Loose Key |



4515 East 139th Street
 Grandview, MO 64030
 (800) 362-9055
 Fax (800) 362-1463
 www.PRIER.com

Replacement Parts & Stems

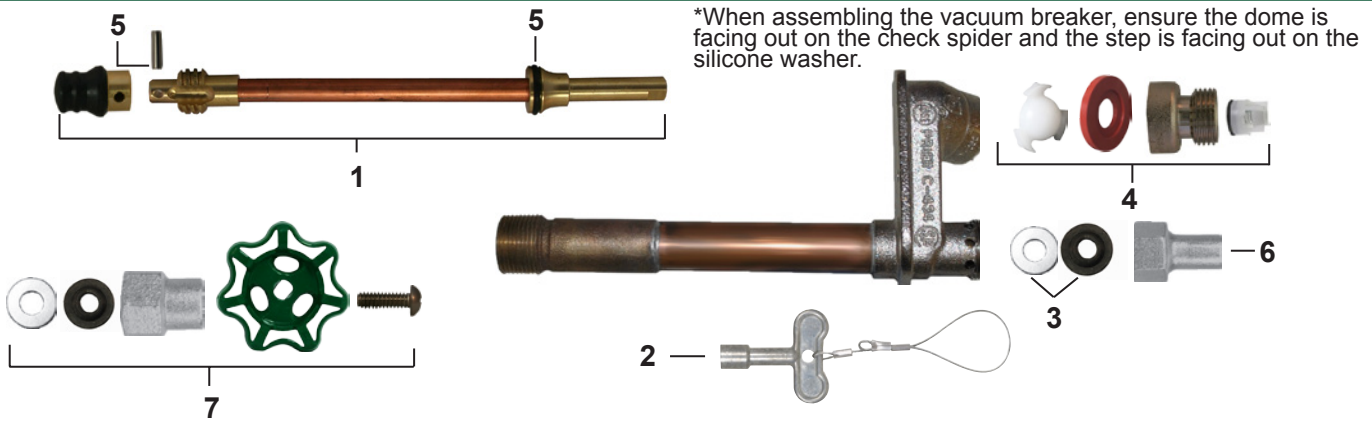

*When assembling the vacuum breaker, ensure the dome is facing out on the check spider and the step is facing out on the silicone washer.

| ID | Part No. | Description | ID | Part No. | Description |
|----|------------|---|----|-------------|---|
| 1 | See Below | Stem Assembly, Contains: 1, 5 | | P-231-0420 | Stem for 20" C-434/C-534 Hydrant, 22 3/4" OAL |
| | P-231-04CC | Stem for CC C-434/C-534 Hydrant, 3 7/8" OAL | | P-231-0422 | Stem for 22" C-434/C-534 Hydrant, 24 3/4" OAL |
| | P-231-0404 | Stem for 4" C-434/C-534 Hydrant, 6 3/4" OAL | | P-231-0424 | Stem for 24" C-434/C-534 Hydrant, 26 3/4" OAL |
| | P-231-0406 | Stem for 6" C-434/C-534 Hydrant, 8 3/4" OAL | 2 | C-108KT-808 | Loose Key on Lanyard |
| | P-231-0408 | Stem for 8" C-434/C-534 Hydrant, 10 3/4" OAL | 3 | C-434KT-903 | Stem Packing and Washer Kit |
| | P-231-0410 | Stem for 10" C-434/C-534 Hydrant, 12 3/4" OAL | 4 | C-434KT-906 | Vacuum Breaker Repair Kit |
| | P-231-0412 | Stem for 12" C-434/C-534 Hydrant, 14 3/4" OAL | 5 | C-434KT-902 | Stopper and Pin Kit (with tool and o-ring) |
| | P-231-0414 | Stem for 14" C-434/C-534 Hydrant, 16 3/4" OAL | 6 | 300-1021 | Valve Stem Cap for C-534 |
| | P-231-0416 | Stem for 16" C-434/C-534 Hydrant, 18 3/4" OAL | 7 | C-534KT-804 | Handle Conversion Kit to C-434 |
| | P-231-0418 | Stem for 18" C-434/C-534 Hydrant, 20 3/4" OAL | | C-534KT-907 | Overhaul Kit for C-534, Contains: 2, 3, 4, 5, 6 |

For the **old style C-534 Series wall hydrant stems, see C-534 Series retired style spec sheet at www.PRIER.com.

Rough-In Dimensions Specs

Cross Section Top View

Front Face Plate View

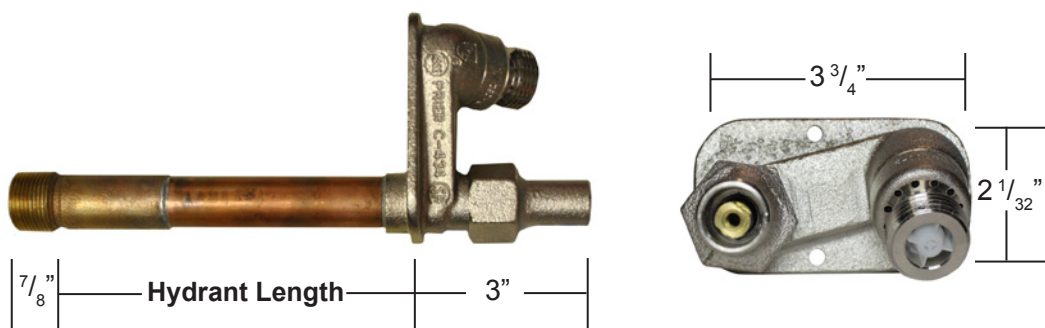

Furnish and install Freezeless Model C-534 Commercial Wall Hydrant as manufactured by PRIER Products, Inc. Hydrant shall have automatic draining capabilities with integral ASSE 1052 approved double check vacuum breaker/backflow preventor. Hydrant shall have 3/4" hose connection with freezeless water flow and self-draining functions. After hydrant is turned in the "off" position, hydrant must be capable of draining even with the hose attached and under pressure without sprayback. Hydrant shall be constructed of all non-ferrous materials with EPDM sealing mechanisms. Hydrant body must be satin nickel plated. For stability of operation, hydrant stem shall be secured at the seat end with ACME type threads and at the handle end with the packing nut. Lockshield must be long enough to ensure operation only with the included operating key.

Hydrant must be installed through a 1 1/8" diameter hole without any custom brick cutting. Hydrant body shall incorporate proper drainage pitch to ensure proper drainage. Operating Key is to be furnished with each hydrant. Hydrant insertion length to be 2 inches. *Close coupled to 24" in 2" increments.