

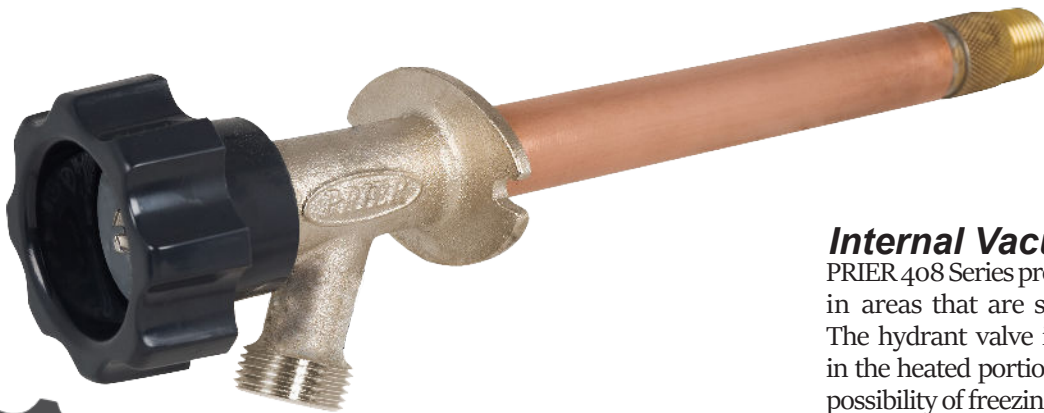

# 408 Series Freezeless Wall Hydrant



- Residential
- Freezeless
- Anti-Siphon
- Backflow Check Valve

### Internal Vacuum Breaker

PRIER 408 Series provides a year round source of water in areas that are subject to freezing temperatures. The hydrant valve is connected to the supply piping in the heated portion of the structure, eliminating the possibility of freezing. The PRIER 408 Series features a half turn design for years of easy operation.

The PRIER 408 Series has all the characteristics of the historically proven 400 Series Wall Hydrant, but the design of the 408 Series incorporates the vacuum breaker and backflow preventer into the operating stem, eliminating an external vacuum breaker on top of the valve.

## FEATURES

- Internal vacuum breaker and backflow preventer
- Easy half-turn operation
- Integral cast flange with built-in drainage pitch
- Wide screw holes easily secure mounting screws
- Solid brass body and seat
- Per ASSE 1019, pressure rated to 125 PSI, temperature to 140°
- Satin nickel plated body maintains an attractive finish
- Stainless steel screws
- Easy grip polycarbonate operating handle
- AFG teflon and graphite packing for easy maintenance
- Each valve air-tested at factory for leak-free quality
- Spout aligning mark with manufacturer's date code

## ORDERING

# 408-10

### Inlet

- 08-D- 1/2" MPT x 1/2" SWT
- 09-T- 3/4" MPT x 1/2" FPT
- 12-F- 3/4" SWT
- 20-X- 1/2" Crimp PEX
- 21-W- 1/2" Wirsbo® PEX

### Length

- 04- 4" Insertion
- 06- 6" Insertion
- 08- 8" Insertion
- 10- 10" Insertion
- 12- 12" Insertion
- 14- 14" Insertion

## INLET STYLES



**D Style**  
1/2" MPT x 1/2" SWT

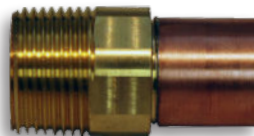

**T Style**  
3/4" MPT x 1/2" FPT



**F Style**  
3/4" SWT



**X Style**  
1/2" Crimp PEX

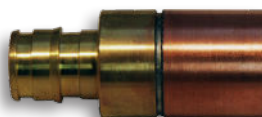

**W Style**  
1/2" Wirsbo® PEX

4515 E. 139th Street Grandview, MO 64030 | (800) 362-9055 | PRIER.com

\*Per ASSE 1019 Code, do not leave on for more than 12 continuous hours.

408-N



## 408 SERIES REPLACEMENT PARTS

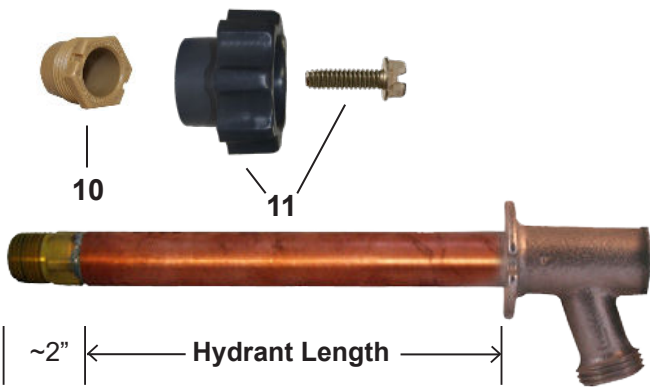
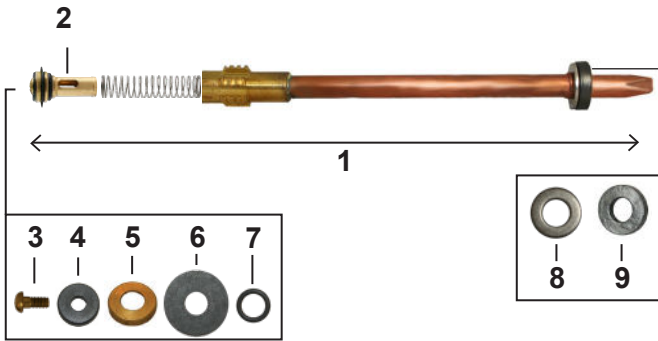

Removable  
Inspection  
Collar

ID	Part No.	Description
1	See Replacement Stem Section	Stem Assembly Contains: 1, 8, 9
2	231-3201	BFP Assembly
3	910-3008	Bibb Screw (Brass)
4	936-3012	Bibb Washer (Rubber)
5	310-3016	Cage Washer (Brass)
6	936-3011	BFP Washer (Rubber)
7	936-3002	Stem End O-Ring (Rubber)
8	324-1006	Washer (Stainless Steel)
9	339-3002	Packing for Left Hand Packing Nut (Graphite)
10	337-3001	Left Hand Thread Packing Nut (Plastic)
11	630-7965	Handle & Screw Kit (Grey Plastic Handle & Stainless Steel Screw)
	630-7755	Service Kit for 300/400/500 Series Contains: 3, 4, 5, 6, 7, 8, 9, 10

\*The 630-7755 Wall Hydrant Service Kit includes parts for the 300, 400 and 500 Series hydrants, some of which are not pictured here. When repairing a hydrant you will have parts left over.

## REPLACEMENT STEMS



Part No.	Stem Length	Description
M-123-4090	8" OAL	Stem for 400 Series Hydrant
M-123-4092	10" OAL	Stem for 400 Series Hydrant
M-123-4093	12" OAL	Stem for 400 Series Hydrant
M-123-4094	14" OAL	Stem for 400 Series Hydrant
M-123-4095	16" OAL	Stem for 400 Series Hydrant
M-123-4096	18" OAL	Stem for 400 Series Hydrant

\*\*400 Series stems are made to fit the 400, 408 and 400-LF Series Wall Hydrants only. They are not interchangeable with any other hydrants. For parts for Mansfield style anti-siphon hydrants made prior to 2007, see the retired 500 Series spec sheet.